[illegible]

F9GI AC 89 5uC			
5uC	6=H	7CADF	D9GC
aa	a		-(Z
\$5	\$5	\$5)*
Dygc HchU	\$5 1		+* -(Z

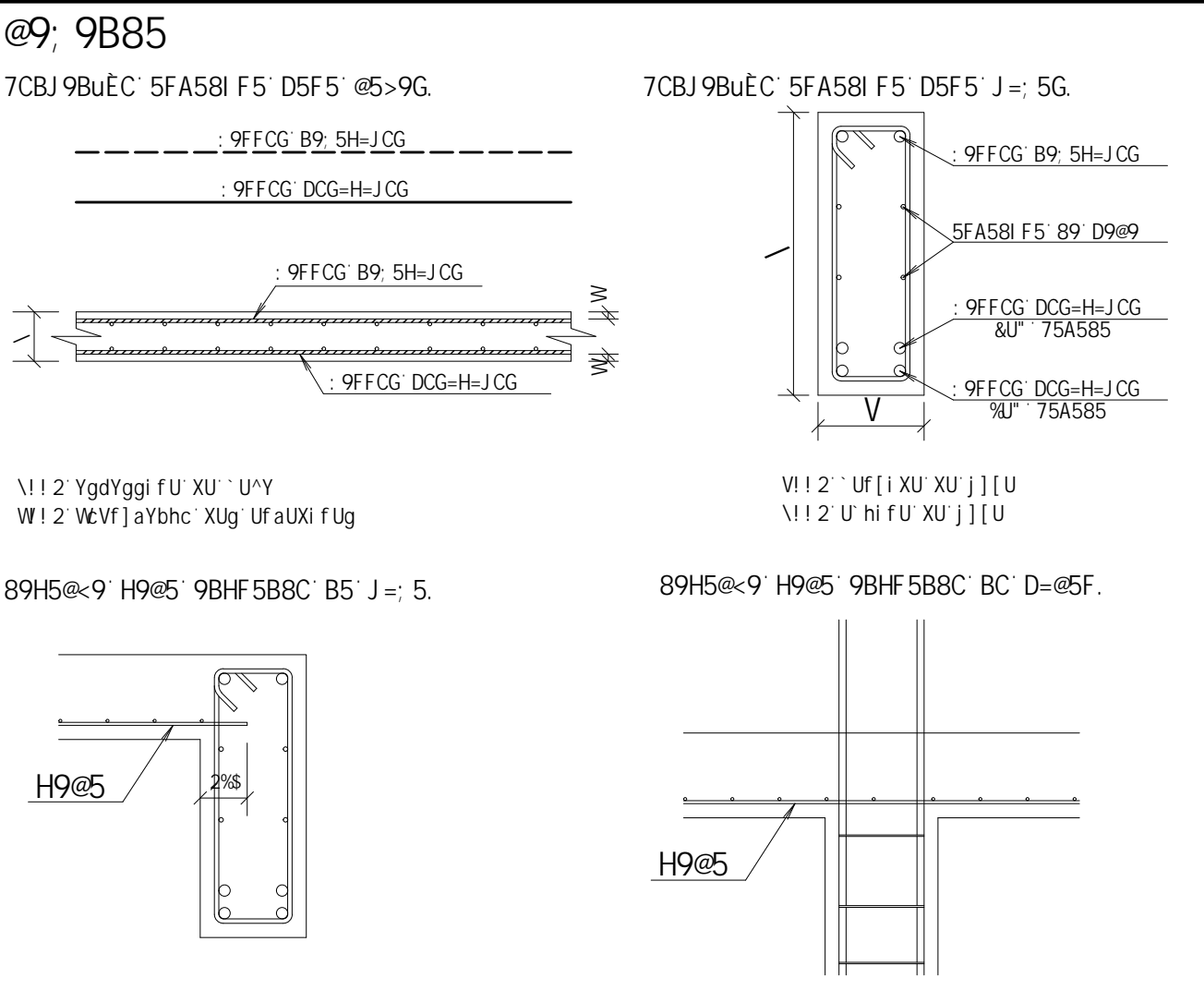

8C6F5A9BHC 85G 65FF5G
G9A 9G75@5

8=aA9HCG 89 8C6F 5A9BHCG

€	751) \$	751 * \$
0 85) €	* €
2 85	. €	11



8

«flaat:) 2\$	* 2'	, 2\$	%22\$	%22)	%2 2\$	&22\$	&) 2\$
Brwaat:	' 2\$	(2\$	(2\$) 2\$	+ 2\$, 2\$	%2 2\$	&22\$

9A9B85G	
6-HC85 flat	HF 58G05G09 flat
7" S	\$2 S
8" S	\$2 S
9" S	\$2 S
10" S	\$2 S
11" S	\$5 S
12" S	\$5 S
13" S	\$5 S
14" S	\$5 S
15" S	\$5 S



```
G=: @5G.
** 1 79BHC 89 : F5J=8589
** 5: 1 7CH5 89 5GG9BHA9BHC 85 : B85uEC
** 1 7CBHF5 : :897<5
```

G=: @5' 8CG' 9@9A9BHCG' 9GHFI HI F5=G.

29; 9B85' 89' D=@5F 9G.

 1' DFCG9: 19  1' ACFF9  1' F981 N  1' B5G79

[illegible][illegible]

ART N°0820250124641

PROJETO ESTRUTURAL

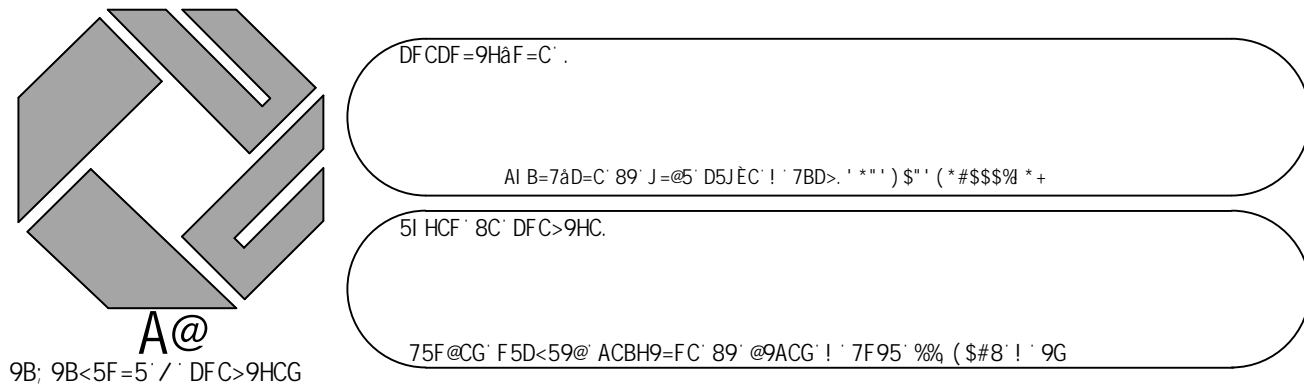

=B: CFA5uÉ9G' 85' C6F5

BWOJT JL6C BS DWSBHS		
SIASUCL BSG J - 5G 8C DSI-ANBHC TCG6H F5		
HWH KC BS G4S 5		
T796HJ JL6C BS T97-9F DEVI QCTQZHS H-DC N 1 T97-9 F 1 SGGQD		
W69W KC BS G4S		
F 49P58GZ B1W6W BP Cdn-H-53 J-MS D51E1F		
DPW0C-0	9045	
VEI-DS9 AIA	S=AA5A	907545 N/3 S
B48C-9F1 JC1 W48	B48C-9F1 JC1 W48	B48S OF 587-5
1001551-1001700 T508 F-1150Z KC	QXGHSF F5M3	S-FXK
F15 TCGZC9C8B515885F S9G 790 A - 10 1 1 S21 B-19F05M-15859QD HMM T1) H4-H8W A - (A4		