[illegible]

5uC		F9GI AC 89	5uC		
6-H		7CADF		D9GC	
\$5	80	a		12	\$5
\$5		38+			%
\$5		15)		%	%
\$5	95	95%		%	%
\$5	92+	%		%	%
\$5				%	%
Dygc HcHu	\$5 1			\$5	Z
Dygc HcHu	\$5 1			&+\$	Z

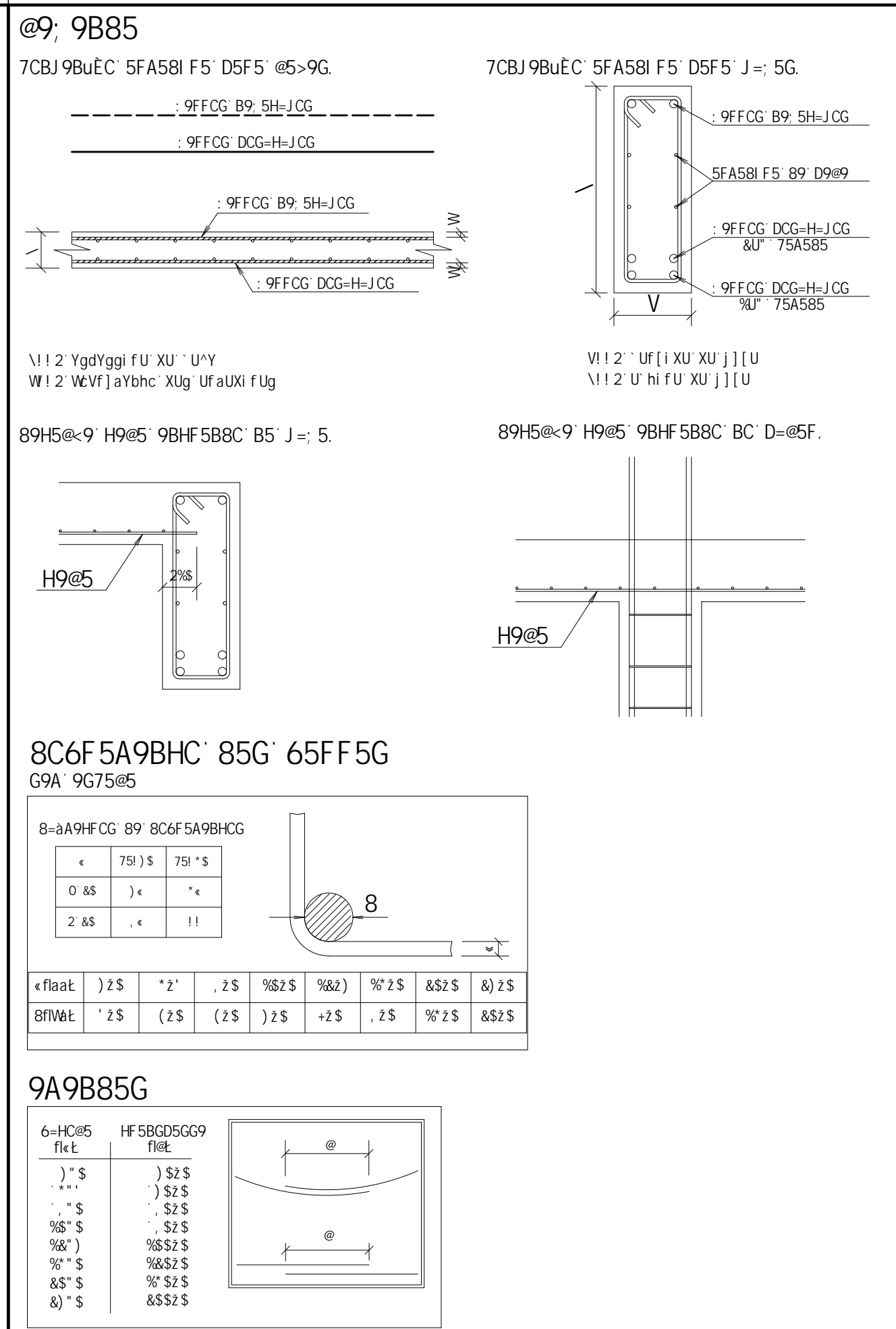
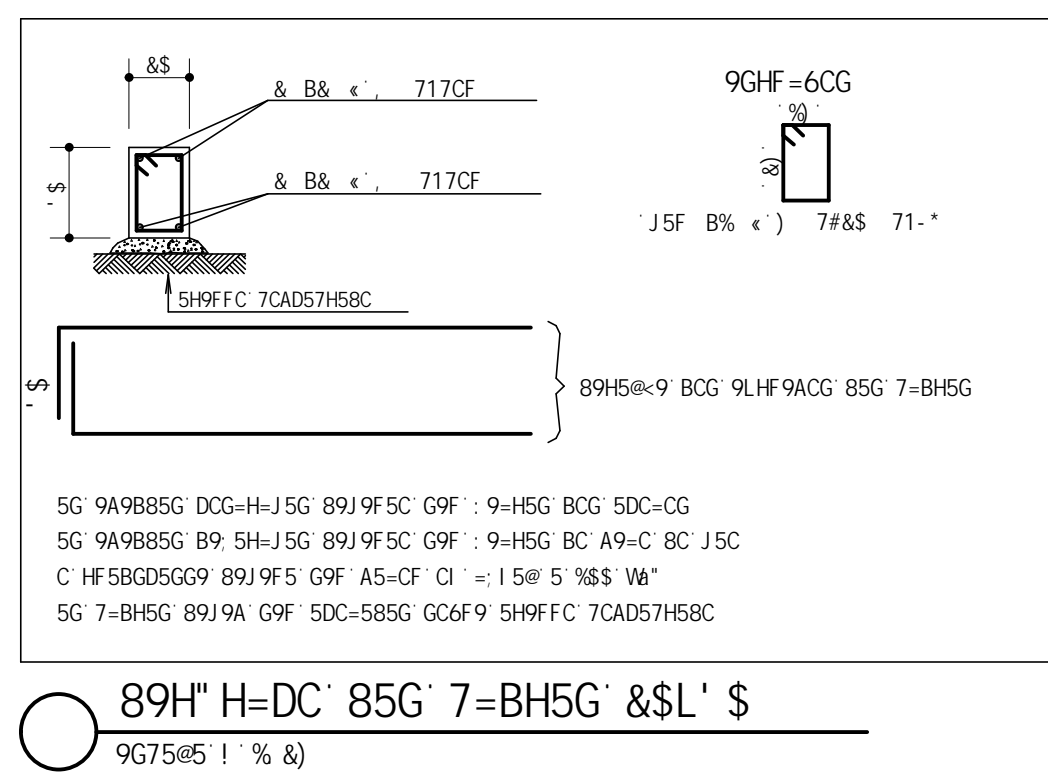
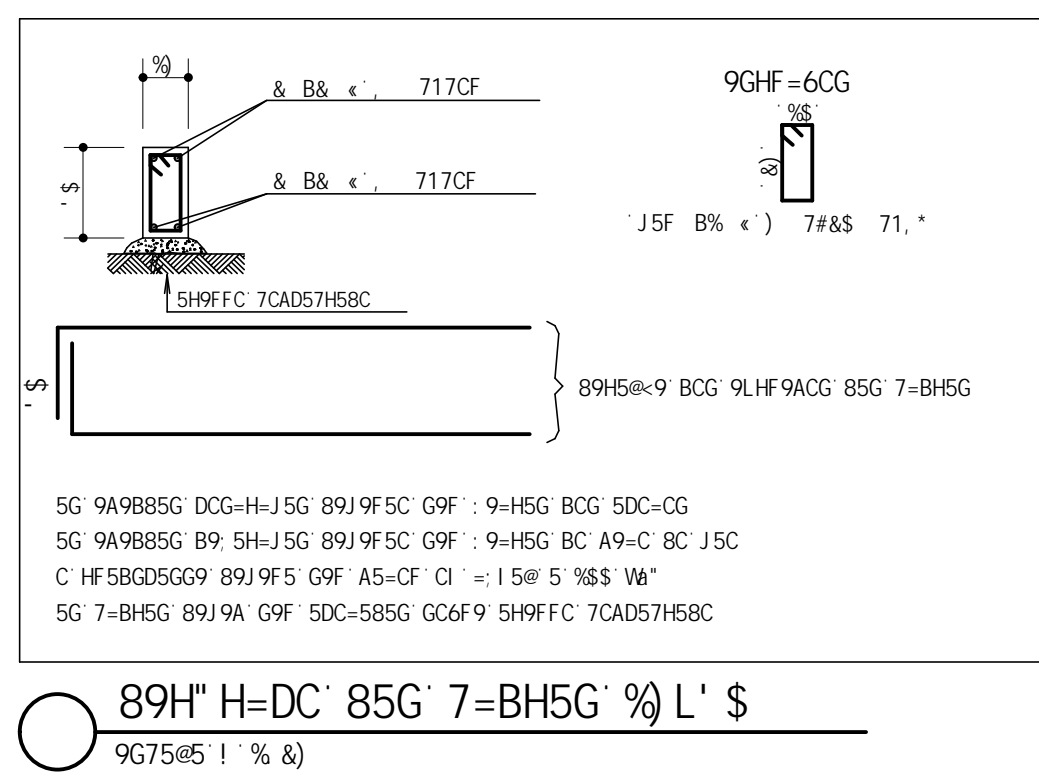
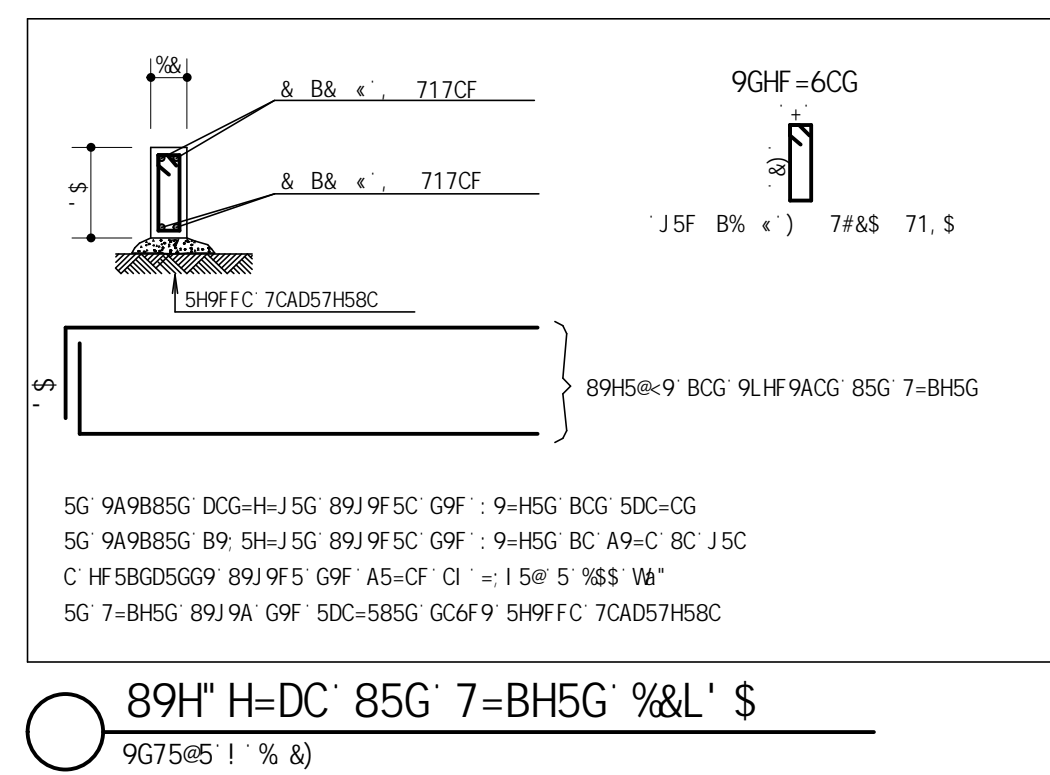
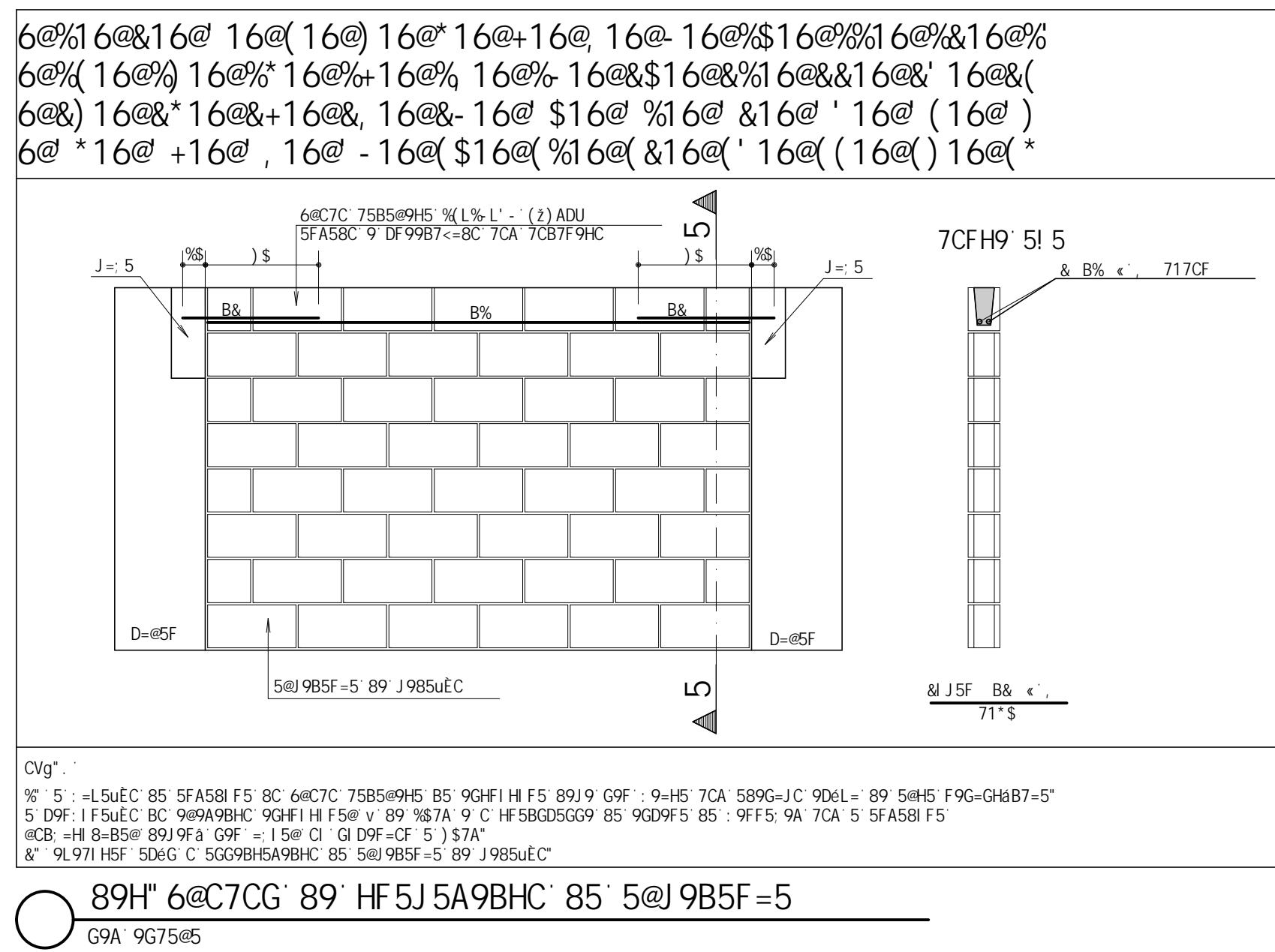
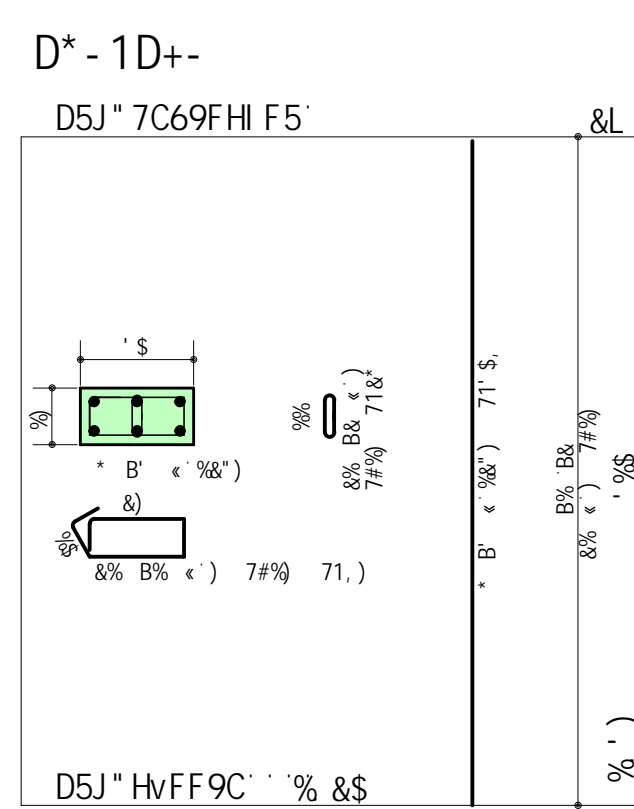
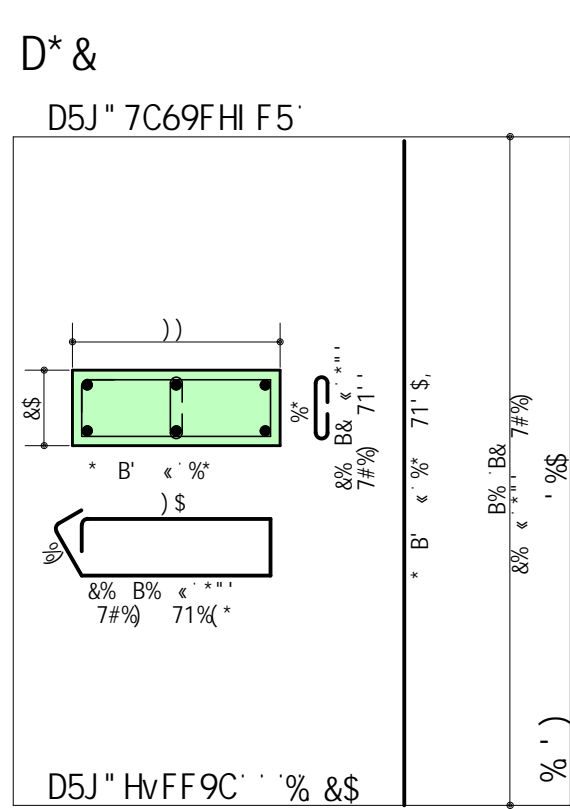
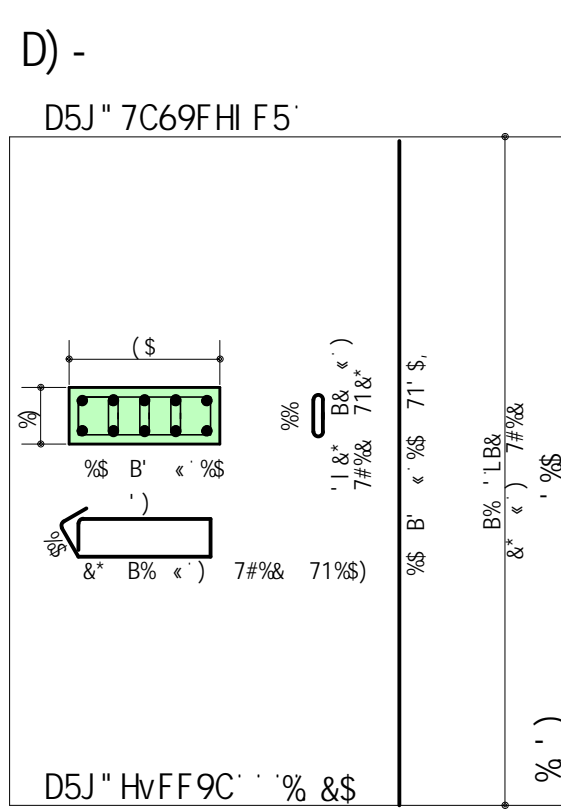
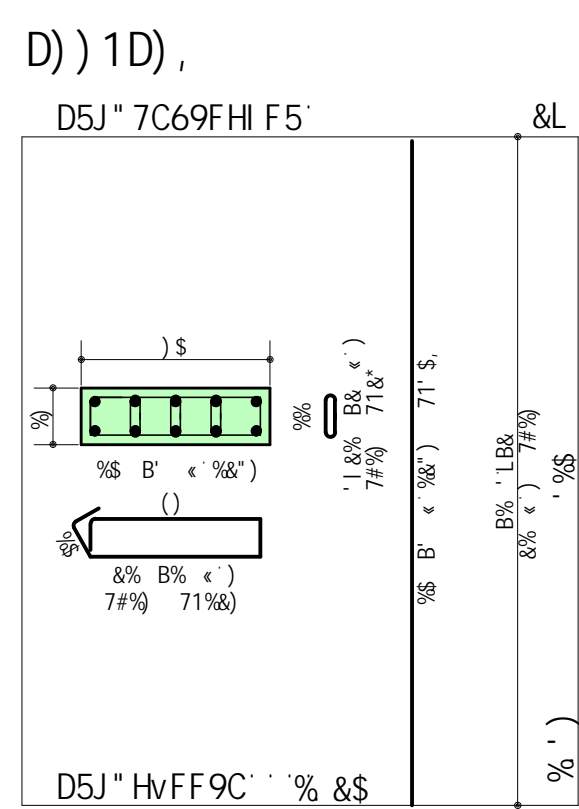

G=: @5G.
7° 1' 79BHC 89° F5J=8589
7° 5' 1' 7CH5 89° 5G99B5A9BHC 85° I B85uEC
7° 1' 7°RHF5 L' @0T.5

G=: @5' 8CG' 9@9ABHCG' 9GHFI HI F5=G.

@9: 9B85' 89' D=@5F 9G.

[illegible]

DFC>9HCG' 89' F9: 9F4B7=5' .
DFC>9HC' 5FE1=H9H8B=7C2' D45BH5G' 65=L5G27CFH9G' 9' : 57<585G

85H5	F9J = G5C Bc*	8 9 G 7 F' = 7 5 C
------	---------------	--------------------

8-#5-#258)	\$%	B-A98GE9G 89 D-e5F9G 9 G5D5H5G 5H 5e-N58CG

[illegible]

ART N°0820250124641

PROJETO ESTRUTURAL

At B=78D=C 89 J=05 D6JEC 1 78D>.'''')\$\$(^*#\$\$\$9'+

51 HCF 8C DFC>9HC.

D. 25.45, 400, 25, 2455

≡B. CFA5UE9G 83 C0F3

5FA5uE'C 80G' D=5F9G' # 89H5@<9 H=DC' 85G' 7=8H5G' # 89H5@<9 6@C7CG' 85' 5@ 985F=5

F* 69F85F8C 81 FE9G 89 08=J9=F52 J=85 D5JEC 9G