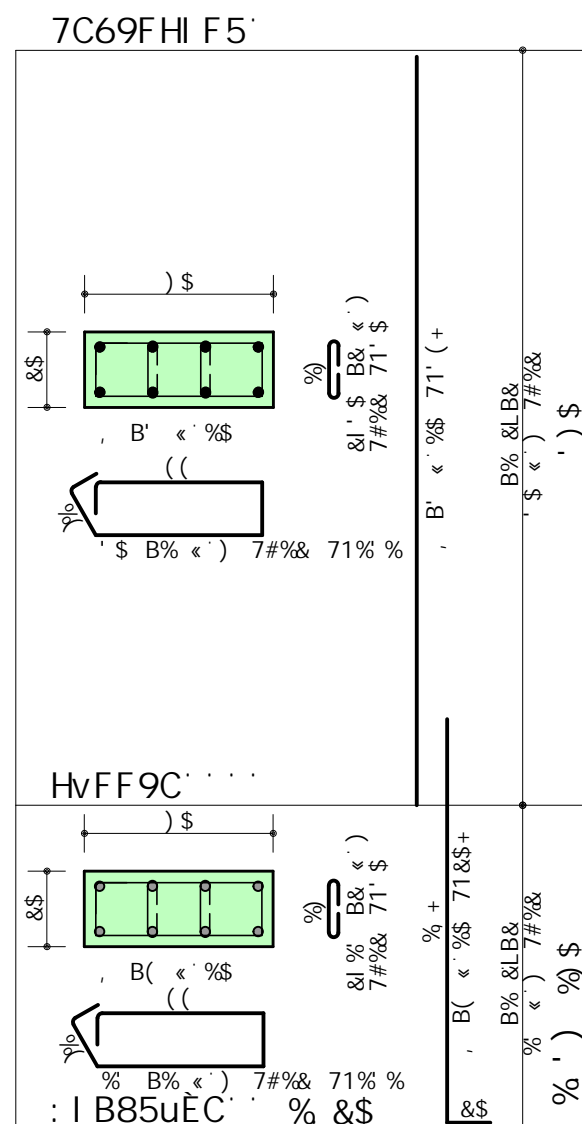
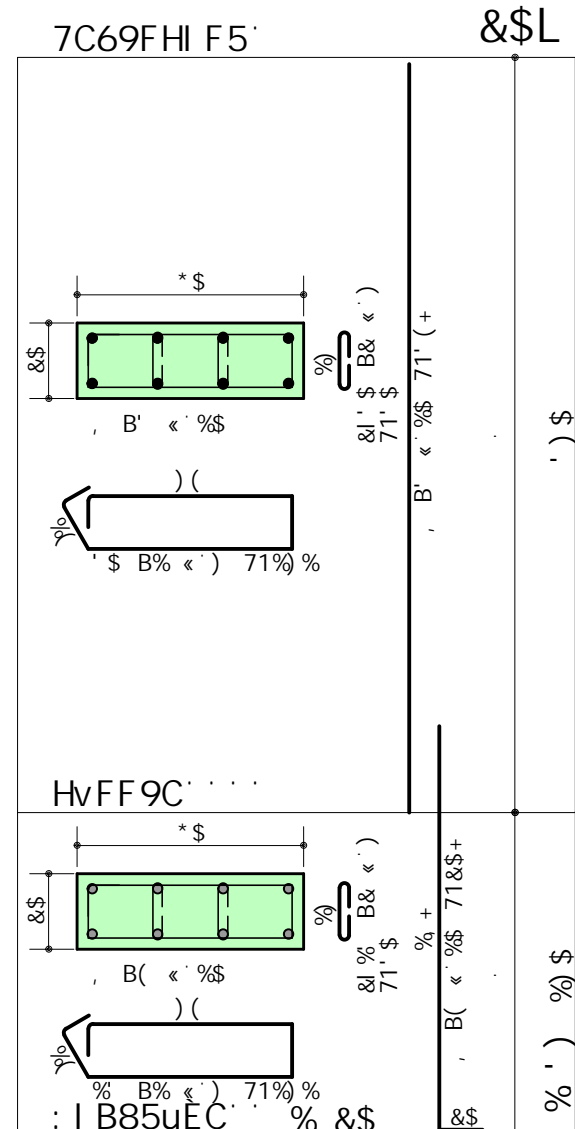
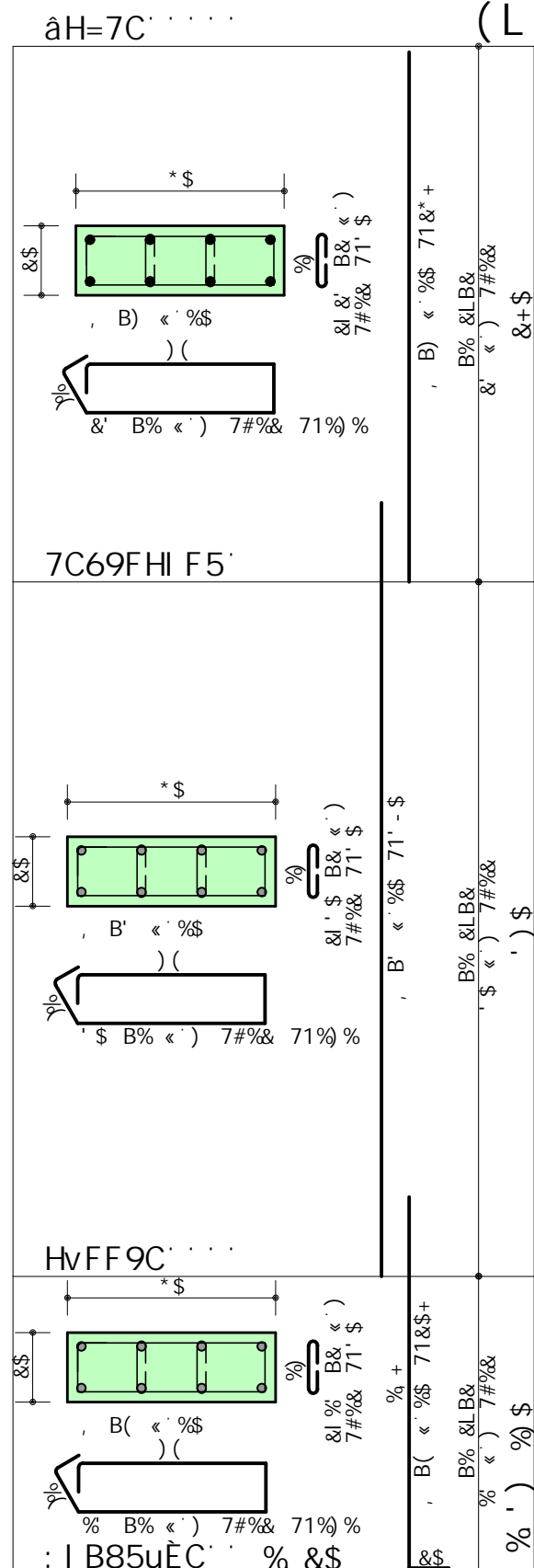
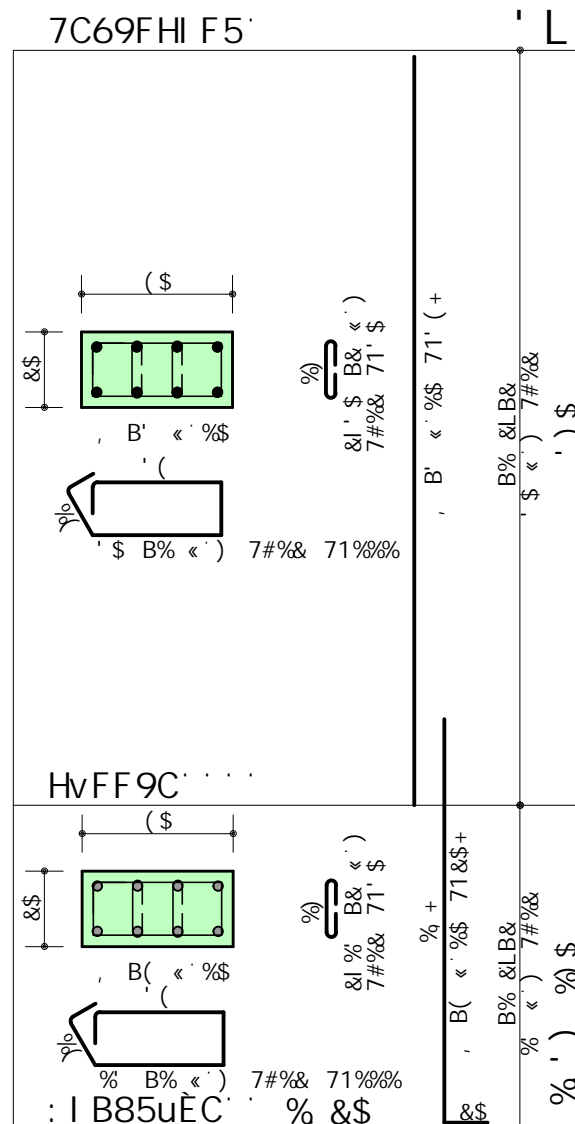
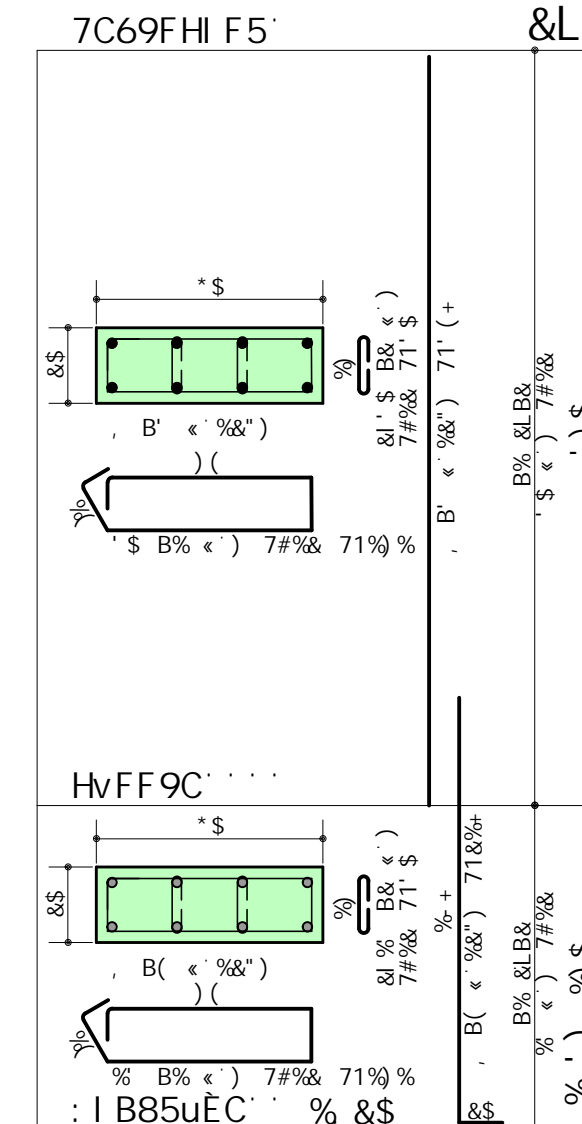

D%

$$\begin{aligned} & D \& 1D^* 1D + 1D, 1D - 1D \% 1D \& \& \\ & D \&^* 1D \& (1D \&) 1D \&^* 1D \& + \\ & D \&, 1D \& - 1D' \$ 1D' \% 1D' \& \\ & D' ( 1D' + 1D' , \end{aligned}$$

D' 1 D( 1 D%%1 D%&

$$D) 1D' \rightarrow 1D' *$$

$$D^0 \rightarrow D^+ \pi^-$$
[illegible]

F9GI AC' 89' 5uC				
5uC	6=H	7CADF		D9GC
aa		a		[ Z
*\$5		(\$ *		* %
*\$5	*\$	% *		* %
*\$5	*(*)	* + (		* (
DYgc HchU		*\$ 5 1		* % Z
DYgc HchU		)*\$ 5 1		% % Z

C6G9F J 5uÉ 9G.

G=; @5G.

7" : 1' 79BHF C 89 : F5J=8589  
7" 5" : 1' 7CH5 89 5G99BH5A9BHC 85 : I B85uEC  
7" : 1' 7CBHF5 ! : @97<5

G=; @5' 8CG' 9@9A9BHCG' 9GHFI HI F5=G.

@9; 9B85' 89' D=@5F 9G.



BCH5G' .

% 7c7uYg Y 8] aYbVg Yg Ya Vw	% 1 BcfaU XY 7Z fUg Y YgVefUaYbhc - B6F %9 - " &55 - f'auYg Y YgVefUaYbhc dUf U Yghfi hi fUg Y YgVbW Yhc Drc'YhczX] aYbJg cblabU dUf Y cFwX] aYbhcY Yl YW hJ] cg
& 7cbWYhc 9Ghf i hi fU' - " Vw 1 ' \$ADU	% 1 BcfaU XY 7Uf [Ug - B6F %9&55% \$ 7UfUg dUfU 7Z W - c XY 9ghfi hi fUg Ya 9X] Z] WU' Y Yg
7cbWYhc 5faUhc - 7] aYbhc Dcfh UbX 7D ==	% 1 BcfaU XY 7Z W - c B6F %9& 65% \$ Drc'Yhc XY 9ghfi hi fUg XY 7cbWYhc fUcX] aYbhc B6F 1 BcfaU XY 1 bXU' Y Yg - B6F %9& &55% \$ Drc'Yhc Y Yl YW - c XY Z] bXU' Y Yg
AGbI' c XY 9 Ugh] WU XUY - 9Wg 1 & * DU	% 1 BcfaU XY [bWbX] c XY VebWYhc - B6F %9 655&65% Drc'Yhc XY Yghfi hi fUg XY VebWYhc Ya g] hi c XY [bWbX] % 1 BcfaU XY Yl YW - c XY VebWYhc - B6F %9 - %9&55% 9l YW - c XY Yghfi hi fUg XY VebWYhc 1 Drc'X] aYbhc % 1 5g BcfaUg Y WUdUg WUaU XY Ya gYf g] i] YghJ huhc bu Y WcfU - c Xg drc'Yhcz el uhc bu Yl YW - c XUg cYfUg
FY U - c z [UfU] caYfUbny Ya aUggu - OIS' * \$	
1 \$, cg -	
75] \$ ! m - 1' \$ \$ ADU	
75] \$ ! m - 1' \$ \$ ADU	
1 7cbWYhc XY FY [i Uf] UJ - c 77 1 %ADU	
AGbI' c XY 9 Ugh] WU XUY - 9Wg 1 % DU	
9gdYggl fU' - " \$Vw	
1 5g VehlUg dYfU Y YWw gcVfY c XYgYbVc	
1 7 UggY XY 5] fYggl] XUY SaV] Ybhu 1 ==	
+1: Uhcf Xc HYfYbhc G% 1 % \$ \$	
1 7UhY] cfU Y XY f] cg] XUYG. G& 1 ==	
-1 7 UggY XU 9X] Z] W - c G& 1 6	
% 1: Uhcf 9ghUhtgh] W: G' 1 % \$ \$	
%98 Y cW XUY 62g WU Xc JYbhc J' 1 ' \$a#g	
%8d 7cVf] aYbhc XUg 5faUhc fUg -	
@U' Yg Ya [YfU' & ) Vw GduhUg - " \$Vw	
@U' Yg DfchYbX] XUg - " \$Vw J] [Ug - " \$Vw	
D] UfYhYg - " \$Vw H V] - c - " \$Vw	
D] UfYhYg - " \$Vw FUX] Yf - " \$Vw	
6 cVeg - " \$Vw	

DFC>9HCG· 89· F9: 9FáB7=5· .

DFC&gt;9HC' 5FEI =H9HeB=7Cz' D@5BH5G' 65=L5Gz7CFH9G' 9': 57&lt;585G

$$F \cdot 9 \cdot J = G \cdot \tilde{E} \cdot C$$
[illegible]

ART°0820210135161

# PROJETO ESTRUTURAL

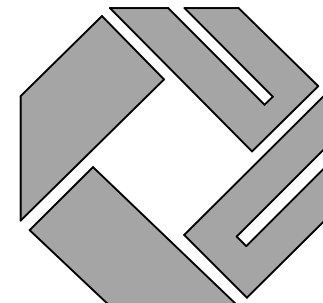
$$DF\ CDF = 9H\&F = C.$$

Al B=7&D=C' 89' J=05' D5J&C' 7BD>.' \*'') S'' (\*#\$\$\$% ^ +

$$5I \text{ HCF} + 8C + 9HC > 9HC$$

A©

9B; 9B<5F=5 / DFC>9HCC

75F@CG F5D<59@ ACBH9=FC 89 @9ACG I 7F95 %%% (\$#8 I 9G

=B: CFA5uÉ9G' 85' C6F5

89G7F=UEC 85' D#5B5H.		
5FA5UEC 8CG D=5F9G		
1H8H @C 85' C6F5.		
7CBGHFIUEC 85' 7A95' 5FH F' D5' 1:B.		
9B89F9UC 85' C6F5'.		
FI 5' DF9G=89BH9 Av8=79Z' G#B '1' B=GHF-HC 89' DF5U5' F=75		
89G9B<CG.	8SH5.	9C75#5.
9E1=D9 A@	G9H9A6FC#&S&.	% +)
B8C< 5FE1=JC' 758.	B8C< DFC<9HC.	B885: DF5B7<5.
\$-& 1\$S) 19GH F\$S' 8K'.	9GHS-&.	\$) #&S
519B=85 9B89G 67<9FF9F' 89' GC1 N5Z8S8S&S) 729BHFC 9ADF 9C5F=5# 85' 69FF5Z G5#6 %%1 79D. & %%)1'. S) D5FE1 9 F9C=8A87<5# 89' d5F5B<9=F5G 99F5F5#9G H9(2)11#8+&'S'S1 \$%< 2)11#8+&'S'S1 &S.		

D%( 1D%) 1D%\* 1D%\_ 1D%-  
D&\$1D&%

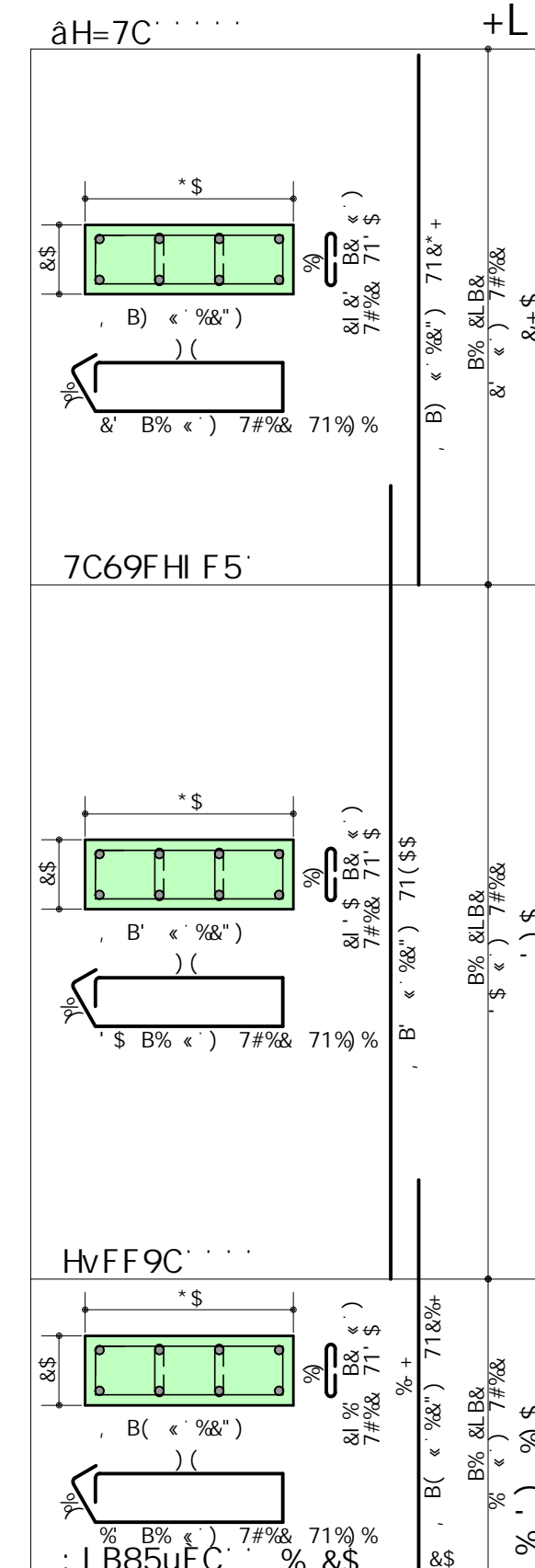
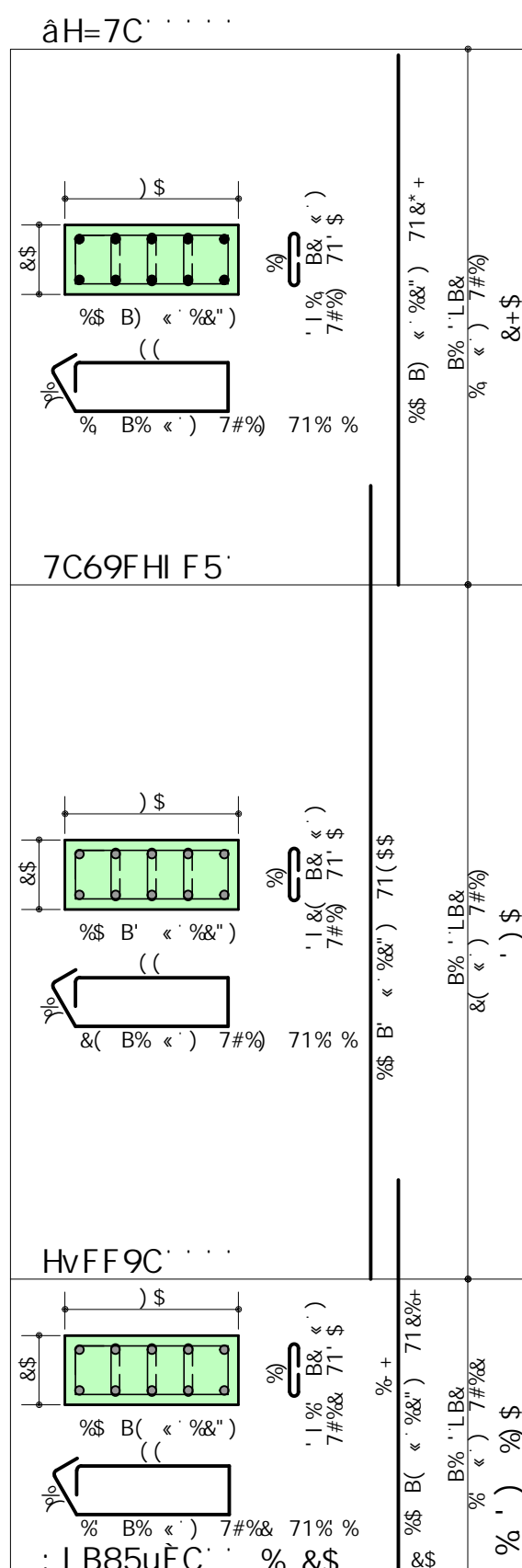
 $D^0_{0+}$ 

D%\$%

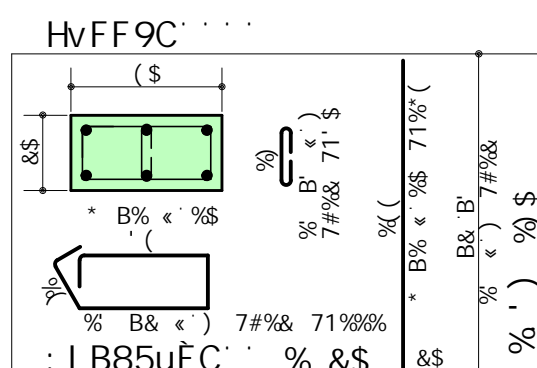

D%\$&1 D%\$' 1 D%\$( 1 D%\$)  
D%\$\* 1 D%\$+1 D%\$,

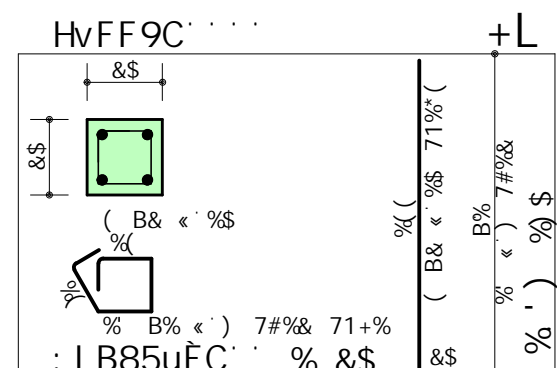

5F@CG'F5D<59@ACBH9=FC'89 @9ACG'D@ \$- &,! \$\$)! 9GH!F\$\$'D@H %- #%%\$#&\$&&% '(\*. \$\$

5F@00